

Pressure Sensor >



Fig. 1

Pressure sensor (Fig. 1) is an element of the environment control system of the CIIM family. It is designed for use in rooms and places where air pressure is a very significant factor e.g. in hallways, server cabinets, rooms with network equipment, or warehouses. It is often used in places with the combined usage of air circulation facilities.

A very important feature is its stability and high reliability through the years thanks to the usage of high quality measurement elements.

The sensor communicates with the central module via a digital interface, which helps to reduce the impact of electromagnetic noise on the measurement accuracy.

The sensor system is enclosed in a holed plastic casing which increases the accuracy and reduces the hysteresis of measurement. The enclosure makes it possible to install the sensor in two ways:

- Using the two mounting holes for screws,
- without using any tools – by using the built-in magnet.

Measurement modules are factory calibrated at the manufacturing stage.

It is supplied as standard with a 2.5-meter cable with a RJ11/RJ10 plug.

Pressure Sensor

To ensure the correct functioning of the sensor, the CIIM/CIIM CC module firmware version must be at least 1.6.0 or later.

Because of the type of the communication protocol used, the sensor must be connected to the bus/input named as Temp/RFID in the central module.

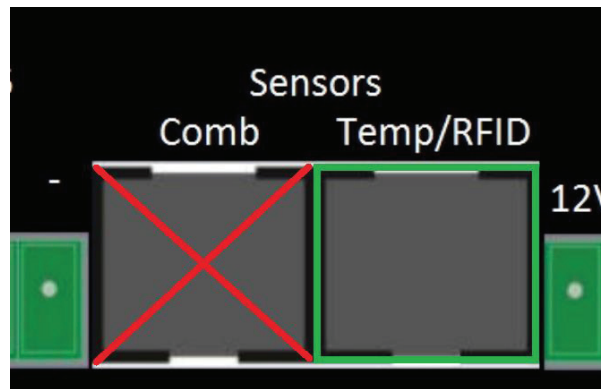

DIMENSIONS

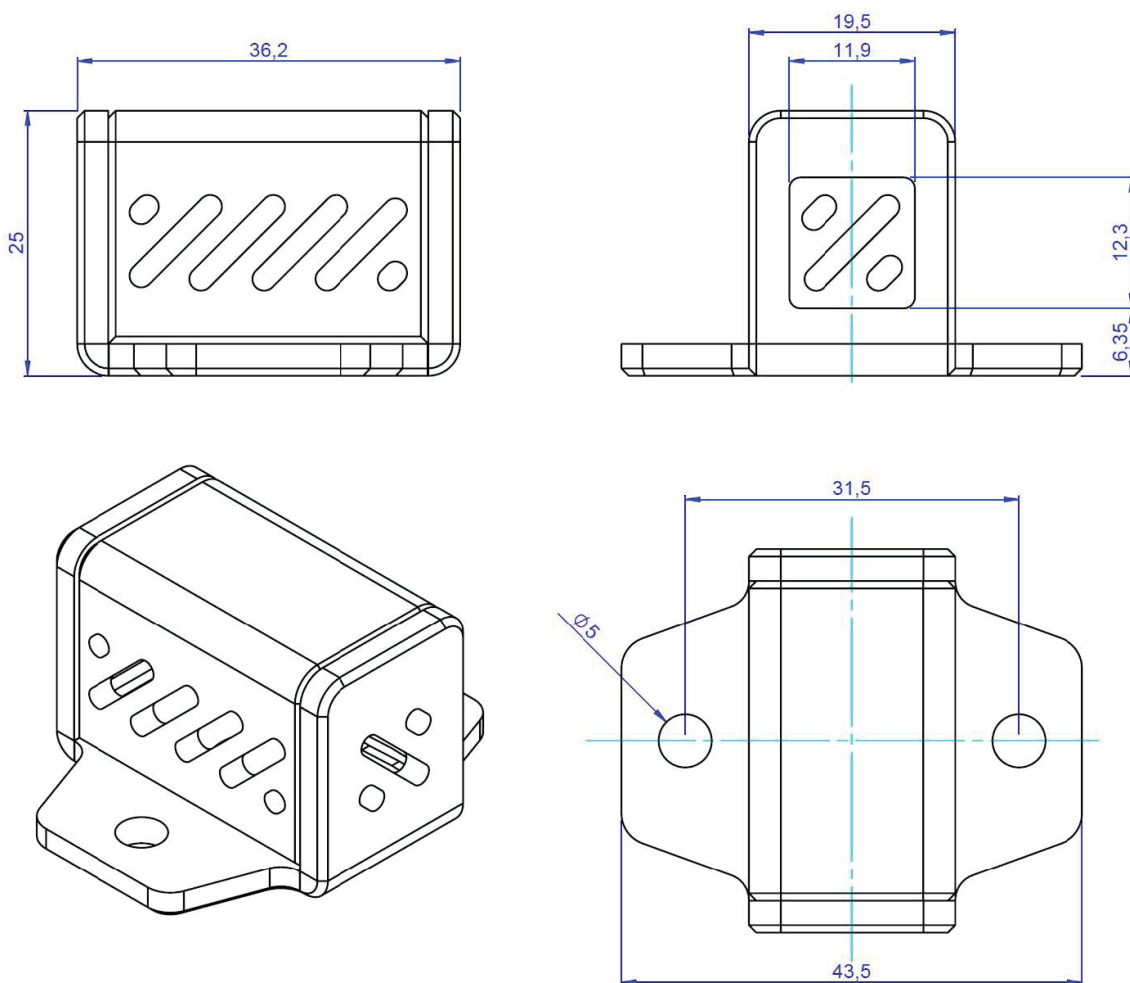

www.molexces.com

Pressure Sensor

SPECIFICATIONS

Power: 5 V DC (from the CIIM system)

Power consumption: 2.5 mA

Electrical connectors: RJ10

Cable length: 2.5 m

Cable end: RJ11

Casing: Plastic (PS)

Measurement range: from 300 to 1100 hPa

Resolution: 0.12 hPa

Accuracy of measurement: 0.12 hPa

Working temperature: -40°C to 125°C

International protection rating: IP20

Weight: 50g net

Casing color: black

Accessories: none

Certificates: CE

Warranty: For warranty information, please contact your local Molex Sales Representative.

ORDERING INFORMATION

Order No.	Description
181030170	Pressure Sensor